

**CURRENT OFFICERS AND MEMBERS OF
STANDING COMMITTEES**

PRESIDENT

Carol M. Worthman (2016–2018)

PRESIDENT-ELECT

Alexandra Brewis Slade (2017-2018)

TREASURER

Jason DeCaro (2017-2020)

SECRETARY

Andrew W. Froehle (2015-2019)

EXECUTIVE COMMITTEE

Program: Amanda L. Thompson (2015–2019)
Public Relations: Michaela Howells (2016–2020)
International: Pablo Nepomnaschy (2017–2021)
Membership: Susan L. Johnston (2014–2018)

NOMINATIONS AND ELECTIONS COMMITTEE

Ivy Pike, Chair (2016–2018)
Aaron Blackwell (2016-2018)
Crystal Patil (2017-2019)
Susan Tanner (2017-2019)

PUBLICATIONS COMMITTEE

Alejandra Nunez-de la Mora, Chair (2015–2019)
Elizabeth Miller (2017-2021)
Josh Snodgrass (2015–2019)
Babette Zemel, Chair (2017–2021)
Lynette Sievert (Editor, AJHB; ex officio)

GREETINGS FROM HBA PROGRAM COMMITTEE CHAIR!

The 43rd Annual Meeting of the Human Biology Association will be held at JW Marriott in Austin, Texas on Wednesday, April 11, and Thursday, April 12, 2018. Pre-registration is less costly and is possible on-line at www.humbio.org through March 22, 2018. Non-members who register for the meeting are also welcome to attend.

The meetings open with a **Poster Session** on Wednesday morning from 8:00-11:00 a.m. This session provides attendees with the opportunity to discuss the presented research one-on-one with individual investigators. One hundred posters (a record number!) will be on display during the session and will be available throughout the day for individual viewing. Two exciting **Breakout Sessions** follow the poster session: one research-focused session on collaborating with indigenous groups effectively and ethically in human biology research and a career-development focused session on establishing a social media presence hosted by our student representatives.

Wednesday afternoon features the **Plenary Session, “Integrating biosocial perspectives to understand health disparities across the lifespan,”** organized by me and Crystal Patil. This session brings together human biologists, epidemiologists, and medical anthropologists to examine health disparities from multiple perspectives and suggest avenues for future research. This year’s **Raymond Pearl Memorial Speaker** is **Dr. Rafael Perez-Escamilla**. He will present **“Food insecurity and the Sustainable Development Goals: From human to planetary health”** at 5 p.m. Dr. Perez-Escamilla is Professor of Epidemiology & Public Health, Director of the Office of Public Health Practice, and Director of the Global Health Concentration at the Yale School of Public Health. He is an international expert on global public nutrition, household food security, and health disparities. He and has served as an expert advisor to numerous national and international maternal and child health programs, has led projects funded by WHO, PAHO, UNICEF, FAO, UNESCO and the governments of Mexico, Brazil, and Columbia, and a member of the U.S. National Academies of Sciences. The day concludes with our members’ **Dinner Reception** from 6:30–9:30 p.m. Please plan to join the festivities!

The scientific program on Thursday, April 12, 2018 consists of 24 podium presentations organized into four sessions: **New directions in human biology: Life course approaches to diet, metabolism and mental health; Age, sex and population variation in hormones and body composition; Social and environmental factors shaping feeding, caregiving and growth; and Social and environmental. factors shaping health and disease**

The **Annual Awards Luncheon** will be held following the morning sessions from 12-1:15 p.m. The recipients of the Edward E. Hunt, Jr., Phyllis Eveleth, and Hilde Spielvogel Awards for outstanding graduate and undergraduate student presentations will be announced and the Executive Committee will present the Franz Boas Distinguished Achievement Award. Tickets are available for advance purchase (and it does sell out!), so please buy your tickets early and join your colleagues to celebrate this year’s awardees. The **HBA Annual Business Meeting** will follow the final podium session and your participation is also encouraged for this event. Thursday’s activities will end with the **Student Reception** from 7:00-9:30 p.m., which is open to all registered student members and shouldn’t be missed!

Friday morning will feature the jointly sponsored AAPA/HBA podium session.

A detailed schedule of presentation and events, abstracts, and an index of presenters follow this summary and is also available at www.humbio.org.

We had a record number of submissions this year –even more than our record-breaking number in New Orleans last year-- so thank you for submitting your work. On behalf of the 2018 HBA Program Committee, welcome to the meetings, thank you for your participation in this exciting group of presentations and events, and enjoy your time in Austin!

*Amanda Thompson
HBA Program Committee Chair*

FLOOR PLANS

LEVEL 2

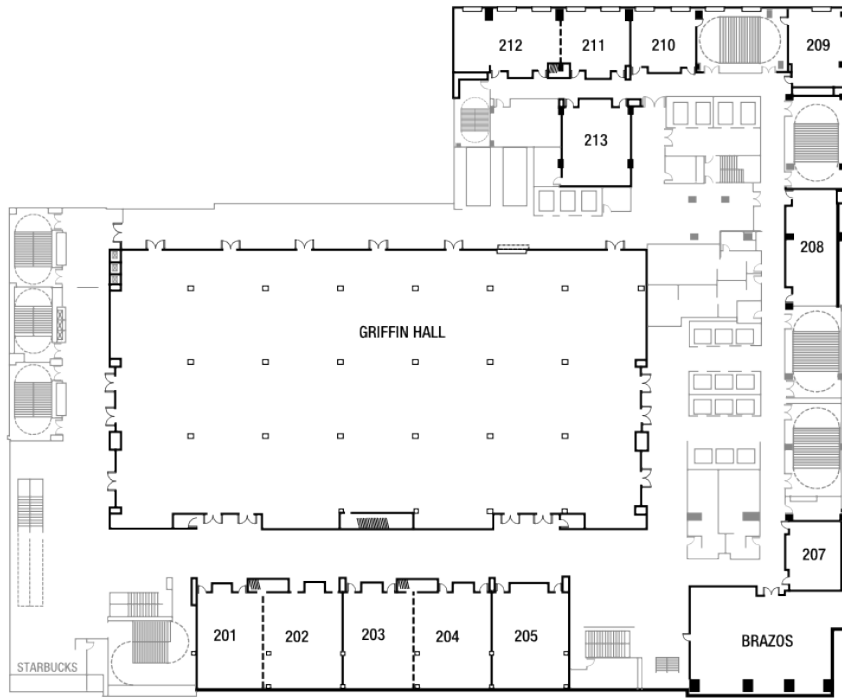

LEVEL 3



**43RD ANNUAL MEETING
HUMAN BIOLOGY ASSOCIATION
PROGRAM SUMMARY
Austin, TX**

TUESDAY, APRIL 10, 2018

6:00 p.m. to 10:00 p.m. **EXECUTIVE COMMITTEE MEETING**
Room: 308

WEDNESDAY, APRIL 11, 2018

7:30 a.m.–9:00 a.m. **AJHB EDITORIAL BOARD MEETING AND
BREAKFAST**
Room: 308

8:00 a.m.–5:00 p.m. **REGISTRATION**
Lone Star West Foyer

8:00 a.m.–11:00 a.m. **POSTER SESSION**
(Set up at 7:00am) Chair: Amanda Thompson
Room: Griffin Hall

11:30 a.m.–12:45 p.m. **LUNCH BREAK**

11:30 a.m. to 12:30 p.m. **BREAKOUT SESSION 1**
**Conducting Respectful and Effective Human Biological
Research with North American Indigenous Populations**
Rachel Wilbur, Ruby Fried, and Savannah Martin, Organizers
Room: Lone Star C

11:30 a.m. to 12:30 p.m. **BREAKOUT SESSION 2**
Establishing Your Online Presence
Katherine Barrett and Mandy Guitar, Organizers
Room: Lone Star B

1:00 p.m.–1:15 p.m. **OPENING WELCOME**
Carol Worthman, President of the Human Biology Association

INTRODUCTION TO PLENARY SESSION
Amanda Thompson and Crystal Patil, Organizers
Room: Lone Star A-C

- 1:15–4:45 p.m. **PLENARY SESSION**
Integrating biosocial perspectives to understand health disparities across the lifespan
Organizers: Amanda Thompson and Crystal Patil
Room: Lone Star A-C
- 5:00–6:00 p.m. **PEARL MEMORIAL LECTURE**
Food Insecurity and the Erosion of Human and Planetary Health: Is There Light at the End of the Tunnel?
Rafael Perez-Escamilla
Yale University
Room: Lone Star A-C
- 6:30–9:30 p.m. **HBA DINNER RECEPTION AND CASH BAR**
Lone Star D

THURSDAY, APRIL 12, 2018

- 7:30 a.m.–8:30 a.m. **REGISTRATION**
Lone Star Foyer
- 8:30–10:00 a.m. **PODIUM SESSION A**
New directions in human biology: Life course approaches to diet, metabolism and mental health
Chair: Gillian Ice
Room: Lone Star B-C
- 10:00–10:15 a.m. **COFFEE BREAK**
- 10:15–11:45 a.m. **PODIUM SESSION B**
Age, sex and population variation in hormones and body composition
Chair: Amanda Thompson
Room: Lone Star B-C
- 12:00–1:15 p.m. **HBA ANNUAL AWARDS LUNCHEON**
Room: Lone Star A
- 1:30–3:00 p.m. **PODIUM SESSION C**
Social and environmental factors shaping feeding, caregiving and growth
Chair: Paul Leslie
Room: Lone Star B-C
- 3:00–3:15 p.m. **COFFEE BREAK**

- 3:15–4:30 p.m. **PODIUM SESSION D**
Social and environmental factors shaping health and disease
Chair: Christopher Lynn
Room: Lone Star B-C
- 5:00–6:30 p.m. **HBA ANNUAL BUSINESS MEETING**
Room: Lone Star B-C
- 7:00–9:30 p.m. **HBA STUDENT RECEPTION**
Room: Brazos

FRIDAY, APRIL 13, 2018

- 8:00 a.m.–12:15 p.m. **JOINT AAPA/HBA SYMPOSIUM**

**43rd ANNUAL MEETING
HUMAN BIOLOGY ASSOCIATION SCIENTIFIC PROGRAM**

WEDNESDAY, APRIL 11, 2018

8:00 a.m.–11:00 a.m.	POSTER PRESENTATIONS Chairs: Amanda Thompson <i>Griffin Hall</i>
7:00 a.m. –8:00 a.m.:	Poster setup
8:00 a.m.–9:30 a.m.:	Authors of odd-numbered posters present for discussion
9:15 a.m. –9:45 a.m.:	COFFEE BREAK
9:30 a.m. –11:00 a.m.:	Authors of even-numbered posters present for discussion
11:00 a.m.–4:30 p.m.:	Posters available for independent viewing
4:30 p.m. -5:00 p.m.:	Poster take-down

POSTER PRESENTATIONS

1. **Evolution misconceptions most improved by implementation of an inquiry-based curriculum: additional insights.** SL Johnston, J Auld, M Knabb, L Rieser-Danner
2. **Perceptions of the Fetal Origins Theory among College-Aged Women Who Have Never Been Pregnant.** L Kihlstrom, A Long, W Fung, E Holbrook, C Wagi, D Himmelgreen
3. **Age at first birth and total fertility: global variation in proximate causes.** K Anderson, L Turner
4. **Hemoglobin levels and time to birth among reproductive-aged women in the Tsimane’ Amazonian Panel Study.** E Miller, M Khalil
5. **Daughters First, Daughters Last: An Evaluation of Birth Sex Ratio by Birth Order in a Mayan Community in Guatemala.** P Nepomnaschy, F Villasenor, T Rapaport, R Altman
6. **Social Support Moderates Testosterone’s Health Effects in a Nationally Representative Sample of Aging US Men.** RG Gengo, RC Oka, M Sarma, JJ McKenna, LT Gettler
7. **Trait or state? Exploring dynamic shifts in men’s sociosexuality based on changes in life history status, familial roles, and testosterone in the Philippines.** L Gettler, PX Kuo, JB Borja, S Rosenbaum, CW Kuzawa.
8. **Is the decline in testosterone with pairbonding or fatherhood attenuated as men age? The challenge of disentangling biology and selection in longitudinal analysis.** C Kuzawa, TW McDade, S Rosenbaum, JB Borja, LT Gettler.

9. **Salivary Testosterone and Adiposity among Shuar Men: Body Composition Variation in an Indigenous, Subsistence Population.** T Gildner, MA Liebert, JM Schrock, SS Urlacher, CJ Harrington, TJ Cepon-Robins, FC Madimenos, RG Bribiescas, LS Sugiyama, JJ Snodgrass.
10. **Come on, get happy! Sleep and happiness predict variation in daily cortisol concentrations in adolescent girls.** M Rodrigues, V. Asenova, KR Allen, MP Rogers, KMN Lee, SR Sanford, J Amos, CD Hunter, KBH Clancy
11. **Hadza hunter-gatherer domiciles provide sleep sites with less overall variation in thermal stress.** D Samson, AN Crittenden, IA Mabulla, AZP.Mabullad
12. **Higher BMI is Negatively Correlated with Less Overall Waking Time Spent Being Active Among Ni Vanuatu.** K Mora, K Gowen, M Li, A Kaneko, L Tarivonda, G Taleo, RM Garruto, JK Lum
13. **Associations between cortisol and C-reactive protein in Cebu, Philippines: C-reactive protein correlated positively with waking cortisol and negatively with diurnal slope.** J Aronoff, CW Kuzawa, J Borja, TW McDade
14. **Is there a relationship between hot flashes, night sweats, and the cortisol awakening response?** G Greenburg, LL Sievert.
15. **Sociodemographic factors, residential location, and allostatic load in rural and urban Poland.** D Hummel, J Jeszka, M Woźniewicz, Y Sone, DE Crews
16. **The physical and psychological impacts of occupational stress experienced by commercial salmon fisherman in Bristol Bay, Alaska.** R Wilbur, JS Griffin, M Sorensen, R Furberg.
17. **Job stress is differentially related to the cortisol awakening response in women with and without a familial risk of breast cancer.** A Baker, JF Manculich, FJ Jenkins, GD James, DH Bovbjerg
18. **Oxidative stress and breast cancer risk: an exploratory analysis of relationships with psychological distress.** M Duris, JF Manculich, FJ Jenkins, GD James, DH Bovbjerg
19. **Changes in overall health and well-being of Americans temporarily living in the Peruvian Amazon.** A Marshall, CY Urista, JE Davis
20. **Effects of psychosocial stress and BMI on c-reactive protein in a student sample.** C Owens, KM Houck, KJ Barrett, AL Thompson, MV Sorensen
21. **Determinants of chronic psychosocial stress in adults within and between islands in Vanuatu.** A Roome, E Standard, G Buffa, G Taleo, L Tarivonda, KN Dancause, KM Olszowy
22. **Does chronic psychosocial stress explain the sex disparity in obesity in Vanuatu?** KM Olszowy, A Roome, E Standard, G Buffa, G Taleo, L Tarivonda, KN Dancause
23. **Identifying risk factors for hypertension in the modernizing island nation of Vanuatu.** E

Standard, A Roome, G Buffa, G Taleo, L Tarivonda, KN Dancause, KM Olszowy

24. **Differences in the effects of stress perception and denial on diurnal ambulatory blood pressure levels in women with and without a parental history of hypertension.** G James
25. **Infant hair cortisol in central Lao PDR.** R Bernstein, DJ Naumenko, J Washabaugh, G-M Hinnouho, MA Barffour, KR Wessells, K Ratsavong, S Kounnavong, SY Hess
26. **Maternal Hair Cortisol as a Measure of Psychosocial stress: Considerations and Findings.** B Evans, BL Turner
27. **Associations between hair cortisol during pregnancy and methylation of hypothalamic-pituitary-adrenal axis regulating genes in cord blood of Brazilian infants.** K Wiley, EC Miguel, GV Polanczyk, V Euclides, H Brentani
28. **Measuring maternal salivary cortisol during homebirths: a new approach to understanding the hormonal physiology of childbirth.** N Falk-Smith, L Madrigal
29. **Connections between perceived and biological measures of stress in early pregnancy in a sample of U.S. women.** G Ritchie-Ewing, BA Piperata
30. **Observations on mothers and newborns' obstetric and anthropometric settings in Cote d'Ivoire.** GZ Euloge, D Noel
31. **Lower depression and greater social support is associated with higher health-related quality of life among postpartum women in western Kenya.** J Yeam, GO Boateng, JD Miller, SM Collins, SL Young
32. **Determinants of Ramadan fasting during the third trimester of pregnancy and influences on infant anthropometry and feeding practices in Rabat, Morocco.** M Guilfoyle, AS Wiley
33. **Pregnancy-related sickness in rural Bangladeshi women.** D Holman, A Pan, Y Navarro, KA O'Connor
34. **Transitional neonatal hypoglycemia: An evolutionary medicine perspective.** DP Kiely Jr.
35. **Inflammatory cytokines in pregnancy and birth outcomes in the Philippines.** HB Ragsdale, C Kuzawa, J Borja, TW McDade
36. **Genome-wide DNA-methylation is associated with pregnancy and lactation and mediated by changes in blood cell composition in young Filipino women.** C Ryan, MJ Jones, MS Kobor, JB Borja, TW McDade, CW Kuzawa.
37. **No change in postpartum prolactin levels following ingestion of encapsulated placenta supplements.** S Young, LK Gryder, CL Cross, D Zava, W Norris, DC Benyshek
38. **Quantifying Immunological Response of Breast Milk to Pathogenic Agents.** D Armstrong, S Li, J Pechera, R Spathis, K Wander.

39. **Characterizing the nutrients and immunological protection provided by mother's milk in Poland.** L Klein, E Goonatileke, A Galbarczyk, C Lebrilla, G Jasienska, K Hinde
40. **Predictors of human milk immune responses to gastrointestinal bacteria.** S Li, D Armstrong, J Pechera, R Spathis, K Wander.
41. **Human milk cytokine responses to gastrointestinal bacterial measured via in vitro stimulation.** K Wander, D Armstrong, S Li, J Pechera, R Spathis.
42. **Maternal iron supplementation during gestation supports infants' iron status between 6 and 11 months: data from a low-income neighborhood in Cali, Colombia.** R Bender, D Dufour, J Reina.
43. **Nutritional status among women and children attending postpartum care clinics in farming and gold mining communities in Northern Tanzania.** E Nyanza Charles, JA. DeCaro, N Basinda, M Ejaredar, E Konje, M Manyama, D Dewey.
44. **High body fat mass in Samoan newborns as possible indication of developmental origins of obesity.** KJ Arslanian, T Atanoa, F Unasa-Apelu, AI Wetzel, A Pomer, RL Duckham, ST McGarvey, NL Hawley.
45. **Infant feeding practices in relation to infant characteristics in Tamil Nadu, India.** L Mattern, AS Wiley
46. **Deciduous tooth emergence and infant feeding practices in the Brazilian Amazon.** J Spence, D Guatelli-Steinberg, B Piperata, B Floyd, HP Silva
47. **The Effects of Infant Birth Weight on Maternal Feeding Style.** C Sweetman
48. **Does maternal grandmother influence grandchildren's dietary intake in poor urban environments?** H Azcorra, F Dickinson, A Vázquez-Vázquez
49. **Exploring the dual burden of malnutrition in mother-child dyads in Vanuatu.** T Wilson, A Roome, E Standard, G Buffa, L Tarivonda, G Taleo, KN Dancause, KM Olszowy
50. **The Ola Tuputupua'e "Growing Up" Study in Samoa: Double Burden of Malnutrition among 4-7 year old Children.** C Choy, C Soti-Ulberg, T Naseri, MS Reupena, RL Duckham, NL Hawley
51. **Distinct HPA activity among Garisakang forager-horticulturalists of lowland Papua New Guinea: Diurnal cortisol rhythms and relationships with prospective child growth.** S Urlacher, MA Liebert, M Konečná
52. **Effects of stunting on body composition, biological age, and muscle strength of Maya and Ladino children in Guatemala.** I Varela-Silva, M Sogut, L Mansukoski, L Millan-Fernandez, S Monserrat-Revillo, B Bogin
53. **Childhood growth disruptions and adult stature: A bioarchaeological investigation of life history in Napoleonic soldiers.** S Holder, Ž Miliauskienė, R Jankauskas, TL Dupras.

54. **Triple whammy: infection by intestinal parasites, anemia and stunting in children from Ocotepc, an agricultural subsistence community in Veracruz, Mexico.** R Rivera-Bonilla, HA Cuevas-Méndez, G Amescua-Villela, S Negrete-Yankelevich, A Núñez- de la Mora
55. **Improved, but not safe: Associations between drinking water and childhood diarrheal disease across seven sites in South Asia and Sub-Saharan Africa.** K McCabe.
56. **Immunoregulatory effects of childhood endotoxemia on total-IgE response: implications for the hygiene hypothesis from Galapagos, Ecuador.** KM Houck, AL Thompson, MV Sorensen
57. **10 years later: analyzing the effect of Western diet on the growth rate of Ni-Vanuatu children since 2007 in Aneityum, Vanuatu.** K Oo, K Gowen, KN Dancause, M Vilar, M Wilson, LE Soloway, C DeHuff, C Chan, L Tarivonda, R Regenvanu, A Kaneko, KM Olszowy, A Pomer, C Sun, H Silverman, G Lee, C Weitz, M Li, RM Garruto, JK Lum
58. **Investigating the Health Effects of the Nutrition Transition Among the Tsimané of Lowland Bolivia.** J Thompson-Vasquez, W Leonard, SN Tanner
59. **A study of dietary transition among indigenous communities in the Northern Ecuadorian Amazon.** G Skletis, MV Sorensen, F Lu
60. **Disconnect between self-perceived health and risk of chronic disease among rural Nicaraguan women experiencing the nutrition transition.** GF Gaitán Arróliga, BA Piperata, N Hoehn, GE Brown, KK Schmeer, J DeCaro, W Wilson
61. **Associations among nutritional status, body fatness, physical activity, ultra-processed foods in the diet and selected socioeconomic factors in adolescents and adults from Merida, Yucatan: A prospective cohort study.** S Datta Banik, MM Torres Arroyo, RM Méndez González
62. **Exploring the relationship between children's dietary adequacy and maternal perceptions of food insecurity in Nicaragua.** EJ Wolfe, BA Piperata, AS Cary, GF Gaitán-Arróliga, KK Schmeer, A Herrera-Rodriguez, VM Salazar-Torres
63. **The impact of household food insecurity on women and children's anthropometric status in Ocotepc, Mexico.** G Stone, G Amescua-Villela, S Negrete-Yankelevich, A Núñez- de la Mora.
64. **Relationship between anthropometrics and dental caries among adults living on islands varying in degree of market integration in Vanuatu.** RC Champion, K Gowen, E Dinh, A Kaneko, RM Garruto, JK Lum
65. **Higher household food insecurity is associated with greater depression among women than men in rural Tanzania.** M Santoso, R Bezner Kerr, N Kassim, H Martin, C Mollay, K Mtei, E Mtinda, SL Young
66. **Cross-Population Comparison of Skeletal Health among Indigenous Bolivian Tsimane and Ecuadorian Shuar of Amazonia.** FC. Madimenos, J Stieglitz, MA Liebert, T Cepon-Robins, SS Urlacher, JJ Snodgrass, LS Sugiyama
67. **Validation of a biomarker of bone resorption in dried blood spots.** G Eick, MJ Devlin, TJ

Cepon-Robins, P Kowal, LS Sugiyama, JJ Snodgrass

68. **Methylation in vitamin D metabolism enzyme genes (CYP2R1, CYP24A1, CYP27A1, CYP27B1) and the vitamin D receptor (VDR) gene in Cebu.** J Perez, TW McDade
69. **The utility of geographic information science in patterning anthropometric variation across Latin American populations.** C Wolfe
70. **Biomass cooking fuel is associated with increased risk of anemia among women in Ghana.** G Boatang, EA Adams, A Lin, P Mbullo, SL Young
71. **Biomass fuel burning and blood pressure modification: a systematic review and meta-analysis.** D Dillon, GD Webster
72. **Testing the Biophilia Hypothesis: effects of walking in forested versus built environments on stress and anxiety.** E Kosleka, AJ Lee, HM Cetrone, A Minasov, WR Leonard, TH Horton
73. **Relationship between autoimmune disease and toxicant exposure.** F Lee, MV Gallo, LM Schell.
74. **Persistent organic pollutants as predictors of increased FSH:LH ratio.** MV Gallo, J Ravenscroft, DO Carpenter, LM Schell, Akwesasne Task Force on the Environment
75. **Does individual weight perception influence risk of cardiovascular disease when controlling for BMI?** JM Cullin, KE White
76. **Adiponectin and the pathogenesis of cardiovascular disease: a global comparison of the utility of adiponectin as a predictor of cardiovascular disease risk.** J Griffin, M Sorensen, AP Barsukov, TM Klimova
77. **Influence of resting metabolic rate on weight gain among Chicago area residents.** K Dong, J Thompson-Vasquez, SB Levy, WR Leonard
78. **Body size, body image and chronic disease among Batswana adults.** G Ice, G Gast, JA Bianco, M Marape, S Maruapula, C Kamanda, E Harper, T Keakabetse, C. Kingori, Z Haile
79. **Activity and body size among Batswana adults.** J Gast, Z Haile, J Bianco, M Marape, S Maruapula, C Kamanda, E Harper, T Keakabetse, A Goetsch, R Onusko, G. Null, D. Spaeth-Cook, G Ice
80. **Longitudinal adiposity change and CREBRF p.Arg457Gln genotype among Samoans.** ST McGarvey, RL Minster, DE Weeks, T Naseri
81. **Cardiometabolic health among Purepecha in North Carolina.** I Godinez
82. **An ADHD-associated polymorphism in the DRD4 gene and nutritional status among Rendille children in northern Kenya.** R Tennyson, K Wander, TW McDade, B Shell-Duncan, DTA Eisenberg

83. **mtDNA variation among the south coast, highlands, and north coast of New Guinea.** K DeRosa, C Almeter, N Benjamin, M Citron, C Fugina, A Guyon, S Hernandez, E Jelen, M Montes, M Moran, C Ronen, N Salazar, P Velazquez, S Velazquez, M Li, A Roome, R Spathis, RM Garruto, JK Lum
84. **Mitochondrial DNA analysis of the South American Wapishana population.** C Koch, DA Merriwether
85. **Household chaos predicts deficits in infant cognitive development.** M Fox, L Glynn, C Sandman, E Davis
86. **Large within subject variance in childhood cognitive ability scores of Guatemalan high SES individuals born 1943-1953.** L Mansukoski, E Hogervorst, K Brooke-Wavell, LR Furlan, JA Gálvez-Sobral, B Bogin
87. **Infant temperament in U.S. family systems: Correlations with parental care, psychobiology, and mental well-being.** M Conklin, JM Braungart-Rieker, EM Cummings, JB Lefever, PX Kuo, LT Gettler
88. **The interaction between adverse childhood experiences and polygenic risk score in relation to body mass index in young adulthood.** Y Inoue, M Graff, CL Avery, HM Highland, KM Harris, KE North, P Gordon-Larsen
89. **Association between early life experience of parental deprivation and cellular immune function among adults in rural Fujian, China.** A Yazawa, Y Inoue, G Cai, R Tu, F He, T Yamamoto, C Watanabe
90. **The low male voice is an honest signal of mucosal immunity. Converging evidence from two samples.** CR Hodges-Simeon, S Arnocky, G Albert, M Gurven, SJC Gaulin
91. **Tatau and the hygiene hypothesis: Retesting the inoculation effect of tattooing in American Samoa.** C Lynn, M Howells, D Herdrich, J Ioane, D Hudson, ST Wilson Fitiao
92. **Diurnal cortisol rhythms and helminth infection intensity among the indigenous Shuar of Amazonian Ecuador: examining immune-endocrine interactions in a subsistence-based population.** MA Liebert, TJ Cepon-Robins, TE Gildner, SS Urlacher, FC Madimenos, CJ Harrington, RG Bribiescas, LS Sugiyama, JJ Snodgrass
93. **Effects of seasonal behavior on the spread of disease in a model of the 1918 influenza pandemic.** J Dimka
94. **The relationship between the tissue sequestration of *Borrelia burgdorferi* within *Peromyscus leucopus* and human clinical symptomatology of Post-Treatment Lyme disease.** J Townsend, A Tricoche, A Rahat, R Behler, Z Abbate, A Baker, R Bright, YJ Cen, R Champion, A Costello, M Duris, A Ferrier, B Kopping, A Krichmar, R Maitland, S Maksimyan, A Moreno, A Negrin, A Saju, E Standard, R Spathis, A Roome, RM Garruto.
95. **Sexual role and HIV set point viral load among men who have sex with men.** S Stansfield, JE Mittler, GS Gottlieb, JT Murphy, DT Hamilton, R Detels, SM Wolinsky, LP Jacobson, JB

Margolick, CR Rinaldo, JT Herbeck, SM Goodreau

96. **“Fingga blo yu no gat olsem mak, mama blo yu gat wori taem yu stum lo bel”**: an analysis of fingerprint asymmetry in Vanuatu. K Gowen, M Li, A Kaneko, L Tarivonda, G Taleo, RM Garruto, JK Lum
97. **Facial asymmetry correlates with geography more than ecology**. K Ramirez
98. **Costs of facial beauty in females – the case of oxidative stress**. A Ziomkiewicz, U Marcinkowska, A Galbarczyk, M Klimek, G Jasienska, R Bribiescas
99. **Quantifying human uniqueness through phylogenetic comparative methods**. IF Miller, RA Barton, S Churchill, CL Nunn

WEDNESDAY, APRIL 11, 2018 (CONTINUED)

11:30 a.m.–12:45 p.m. **LUNCH BREAK**

11:30 a.m. –12:30 p.m. **BREAK-OUT SESSIONS**

BREAKOUT SESSION 1

Conducting Respectful and Effective Human Biological Research with North American Indigenous Populations

Rachel Wilbur, Ruby Fried, and Savannah Martin, Organizers
Room: Lone Star C

BREAKOUT SESSION 2

Establishing Your Online Presence

Katherine Barrett and Mandy Guitar, Organizers
Room: Lone Star B

1:00 p.m.–1:15 p.m.

OPENING WELCOME

Carol Worthman, President of the Human Biology Association

INTRODUCTION TO PLENARY SESSION

Amanda Thompson and Crystal Patil, Organizers
Room: Lone Star A-C

1:15 p.m.–4:45 p.m.

PLENARY SESSION

Integrating biosocial perspectives to understand health disparities across the lifespan

Organizers: Amanda Thompson and Crystal Patil
Room: Lone Star A-C

As a holistic field dedicated to understanding the interaction of social, environmental, and structural factors in shaping human biology and health, human biology is well-positioned to address the development and consequences of health disparities across the lifespan. Beyond enriching our understandings of the range of health and developmental outcomes experienced by people of different race/ethnicities, genders, and geographies, however, through their work with communities, human biologists are also well-positioned to suggest potential avenues for the prevention of these disparities. This symposium brings together interdisciplinary researchers –human biologists, medical anthropologists, medical sociologists, and epidemiologists— that incorporate innovative methods and perspectives to examine and address health disparities. The goal of this symposium is to foster broader conversations and inspire new approaches for addressing health inequities.

1:15 pm **Life course and intergenerational pathways for historical trauma to shape health disparities.** ZM Thayer

- 1:45 pm **Untangling Relations: Networks of Care, Adult Labor, and Child Thriving in Jamaica**
RG Nelson
- 2:15 p.m. **Invisible and in the spotlight: Situating sickle cell disease in our teaching and research**
C Patil
- 2:45-
3:00 p.m. **COFFEE BREAK**
- 3:00 p.m. **Applying a biosocial approach to understand stigma and the experience of gender transition among transgender men.**
Z DuBois
- 3:30 p.m. **Modifiable Physical and Social Environmental Factors that likely Contribute to Racial/Ethnic and Socioeconomic Disparities in Cardiometabolic Health.**
CL Jackson
- 4:00 p.m. **Neighborhood characteristics and symptoms in midlife women**
L Gerber and LL Sievert
- 5:00 p.m. **RAYMOND PEARL MEMORIAL LECTURE**
Food Insecurity and the Erosion of Human and Planetary Health: Is There Light at the End of the Tunnel?
R Perez-Escamilla
Room: Lone Star A-C
- 6:30 p.m.-
9:30 p.m. **HBA DINNER RECEPTION**
Room: Lone Star D

THURSDAY, APRIL 12, 2018

- 8:30–10:00 a.m. PODIUM SESSION A: New directions in human biology: Life course approaches to diet, metabolism and mental health**
Chair: Gillian Ice
Room: Lone Star B-C
- 8:30 a.m. **Womb-to-womb: A lifecourse perspective on maternal metabolism during pregnancy**
RL Fried, JB Borja, CW Kuzawa

- 8:45 a.m. **Parental ratings of infant appetite may mediate associations between infant diet and infant size**
K Barrett
- 9:00 a.m. **Perceived food insecurity, dietary quality, and nutritional adequacy among low income Nicaraguan women**
A Cary, BA Piperata, EJ Wolfe, GF Gaitán-Arróliga, KK Schmeer, A Herrera-Rodriguez, VM Salazar-Torres
- 9:15 a.m. **Household food insecurity is associated with menarche among girls in Tampa Bay, Florida**
M Burris, D Himmelgreen
- 9:30 a.m. **Effects of early life stress on physiological responses to chronic and acute stress in midlife in the United States**
EA Holdsworth
- 9:45 a.m. **Early life social experiences as predictors of depression in Cebu, Philippines: Investigating the mediating roles of the HPA axis and DNA methylation**
AW Kim, TW McDade, J Borja, CW Kuzawa
- 10:00 a.m. COFFEE BREAK**
- 10:15–11:45 a.m. PODIUM SESSION B: Age, sex and population variation in hormones and body composition**
Chair: Amanda Thompson
Room: Lone Star B-C
- 10:15 a.m. **Foragers Hard at Work: Sex differences in hormone production, physical activity, and energy expenditure among the Mbenjele**
M Sarma, A Boyette, S Lew-Levy, M Valchy, LT Gettler
- 10:30 a.m. **Maternal mental health and child allostatic load in rural Nicaragua.**
N Hoehn, J DeCaro, B Piperata, K Schmeer, AK Rudkoski, GE Brown, W Wilson
- 10:45 a.m. **Does men’s testosterone rebound as parenting duties decline, or when pairbonds dissolve?**
S Rosenbaum, LT Gettler, JB Borja, TW McDade, CW Kuzawa
- 11:00 a.m. **The adaptive significance of brown adipose tissue: comparative data from the Sakha Republic (Yakutia), Russia and Evanston, IL**
SB Levy, TM Klimova, VI Fedorova, ME Baltakhinova, RN Zakharova, D Atallah, MH Bondy, A Debertin, K Dong, J Thompson-Vasquez, WR

Leonard

- 11:15 a.m. **Estimated body composition of urban school children 6-13 years in Oaxaca, Mexico: A comparison of two equations for Latin American children.**
ME Peña Reyes, RM Malina
- 11:30 a.m. **IGF-I concentrations at 6 years in an Indian Cohort: Associations with body composition and bovine milk consumption**
AS Wiley, HG Lubree, L Ramdas, A Rao, DS Bhat, CS Yajnik
- 12:00–1:15 p.m. HBA ANNUAL AWARDS LUNCHEON**
Room: Lone Star A
- 1:30–3:00 p.m. PODIUM SESSION C: Social and environmental factors shaping feeding, caregiving and growth**
Chair: Paul Leslie
Room: Lone Star B-C
- 1:30 p.m. **A precarious developmental niche: how insecurity shapes nurturing strategies among Turkana women of Kenya**
I Pike
- 1:45 p.m. **Mothering Mothers: The Critical Role of Breastfeeding Support Among Himba Pastoralist**
B Scelza, K Hinde
- 2:00 p.m. **Extended breastfeeding is not enough: infant weaning practices and growth faltering in a subsistence agricultural community in Veracruz, Mexico**
A Nunez-de la Mora, S Molina-Castaneira, AG Perroni-Marañón, S Negrete-Yankelevich, G Amescua-Villela
- 2:15 p.m. **Cross-cultural perceptions of how water insecurity shapes breastfeeding**
R Schuster, MS Butler, SM Collins, SL Young, Household Water Insecurity Experiences (HWISE) Consortium
- 2:30 p.m. **Revisiting the Postnatal Female Growth Buffering Hypothesis: A Test Across 44 Countries**
JA DeCaro, C Hadley
- 2:45 p.m. **Bad for boys, worse for girls: the sex-biased effects of fosterage on nutritional status in Himba children**
S Prall, B Scelza

- 3:00 p.m. COFFEE BREAK**
- 3:15–4:30 p.m. PODIUM SESSION D: Social and environmental factors shaping health and disease**
 Chair: Christopher Lynn
Room: Lone Star B-C
- 3:15 p.m. **Epigenetic mechanisms explain developmental effects on reproductive function**
 G Bentley, R Stöger, RD Emes, B Bar-Sade, K Begum, O Eden, P Melamed
- 3:30 p.m. **Transgenerational inheritance of immunological knowledge: in utero exposure as a cue inducing tolerance and resistance to parasites and pathogens**
 A Blackwell
- 3:45 p.m. **Sleep Duration and Quality are Associated with Immune Markers, Self-Rated Health, and Mortality in a Large Cohort (NHANES 2005-2014)**
 EC Shattuck, CS Sparks
- 4:00 p.m. **Early maturity, shortened stature, and hardship: Life History trade-offs as possible indicators of social stratification and income inequality in the U.S.**
 A Rivara, L Madrigal
- 4:15 p.m. **Children as introducers, herd immunity, and gender differences during the 1918/19 Influenza Pandemic in two island populations**
 L Sawchuk, L Tripp
- 4:30 p.m. **Is age-related decline in urine concentrating ability universal? Hydration biomarkers from the US and Bolivian Amazon**
 A Rosinger, JM Sands. SN Tanner

FRIDAY, APRIL 21, 2018

8:00 a.m.–12:00 p.m. JOINT AAPA/HBA SYMPOSIUM

Please consult the AAPA program for abstracts for the joint session.